

Model No.: B-322(1) Three Piece High Pressure Ball Valves

Sizes range:	1/2" ~ 2" (DN15 ~ DN50)
Port availability:	Full bore
Working pressure:	6000PSI
Temperature rating:	- 20°F ~ 400°F (- 29°C ~ 200°C)
Body material:	CF8M(1.4408), CF3M(1.4409), CF3(1.4309), WCB(1.0619)
Trim material:	Stainless Steel Ball & Stem
End connection:	Threaded end
	Blow-out proof stem design
	On-line maintainable design
	Available with handle locking device upon request

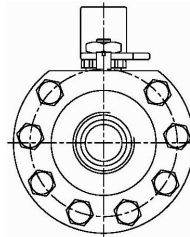
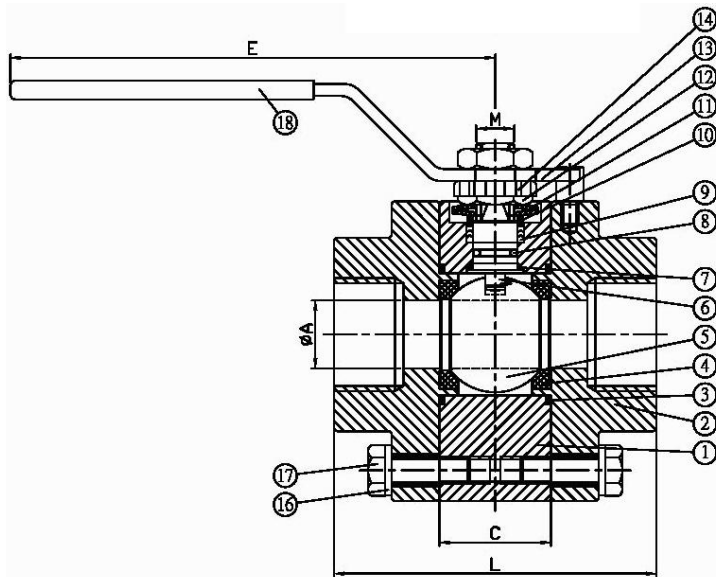
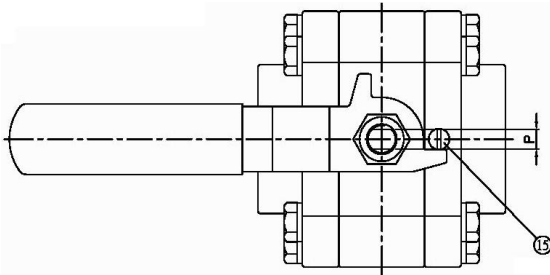

MATERIAL LIST

No.	PART NAME	SPECIFICATION
1	BODY	Stainless St. ASTM A182 F316 Carbon St. ASTM A105
2	END CAP	Stainless St. ASTM A182 F316 Carbon St. ASTM A105
3	BODY SEAL	Delrin
4	SEAT	Delrin / Peek
5	BALL	SS316
6	STEM	SS316
7	THRUST WASHER	Delrin
8	O-RIGN	VITON
9	STEM PACKING	PTFE-25% Carbon Filled
10	GLAND	SS304
11	BELLEVILLE WASHER	SS304
12	STEM NUT	SS304
13	HANDLE	SS304
14	LOCK WASHER	SS304
15	STOP PIN	SS304
16	BOLT WASHER	SS304
17	BOLT	SS304
18	HANDLE COVER	PLASTIC

DIMENSIONS (mm)

SIZE		A	C	E	L	M	P
NPS	DN						
1/2"	15	15.0	33.0	142.0	85.0	M12	9.00
3/4"	20	20.0	33.0	142.0	95.0	M12	9.00
1"	25	25.0	41.0	162.0	108.0	M12	9.00
1 1/4"	32	32.0	50.0	162.0	128.0	M18	14.00
1 1/2"	40	38.0	56.0	200.0	140.0	M18	14.00
2"	50	50.0	71.0	200.0	163.0	M18	14.00