

Model No.: B-115 1-Piece Ball Valve Hexagonal Type

Sizes range:	1/4" ~ 2" (DN 8 ~ DN 50)
Port availability:	Reduce port
Working pressure:	1/4" ~ 1" 2000 WOG (140 bar) 1 1/4" ~ 2" 1500 WOG (105 bar)
Temperature rating:	- 20°F ~ 350°F (- 29°C ~ 180°C)
Body material:	ASTM A 351, CF8M (1.4408)
Trim material:	Stainless Steel Ball & Stem
End connection:	Threaded End
Seat material:	PTFE
	Blow-out proof stem design

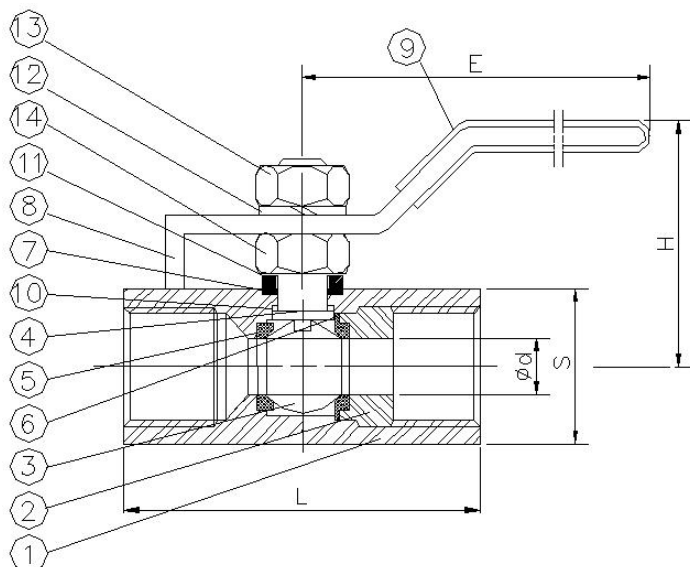
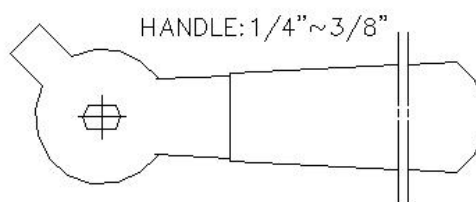
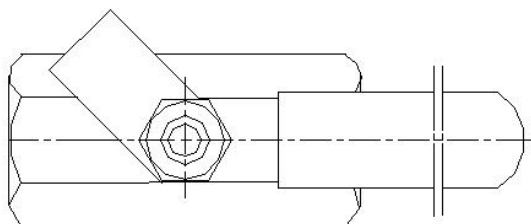

MATERIAL LIST

No.	PART NAME	SPECIFICATION
1	BODY	ASTM A351 GR. CF8M
2	SEAT RETAINER	ASTM A351 GR. CF8M
3	BALL	ASTM A351 GR. CF8M
4	STEM	S.S.316
5	BALL SEAT	RPTFE
6	CAP SEAT	PTFE
7	PACKING	PTFE
8	HANDLE	S.S.304
9	HANDLE SLEEVE	VINYL GRIP
10	THRUST WASHER	PTFE
11	GLAND	S.S.304
12	WASHER	S.S.304
13	HANDLE NUT	S.S.304
14	STEM NUT	S.S.304

DIMENSIONS (mm)

SIZE		φd	H	S	E	L	Cv factor (Kv= 0.853 Cv)	W (kg)
NPS	DN							
1/4"	8	5	29	17.5	61	46	1.0	0.08
3/8"	10	7	35	21	80	51	2.5	0.12
1/2"	15	9.2	66	28.5	104	56	5.5	0.28
3/4"	20	12.5	69	34.5	107	65	10.0	0.44
1"	25	15	75	40.5	118	76	15.5	0.61
1 1/4"	32	20	78	53.5	146	92	20.0	1.26
1 1/2"	40	25	85	57.5	148	98	37.0	1.42
2"	50	32	98	73	150	114	60.0	2.68